



CORIOLIS COMPACT QUICK USER'S GUIDE

/ Contents of the Coriolis compact case



- 1** – Coriolis compact transport box
- 2** – Power supply
- 3** – Coriolis Compact
- 4** – Collection cone kit with caps (by10)



CORIORIS COMPACT QUICK USER'S GUIDE

/ Setting up the Consumable

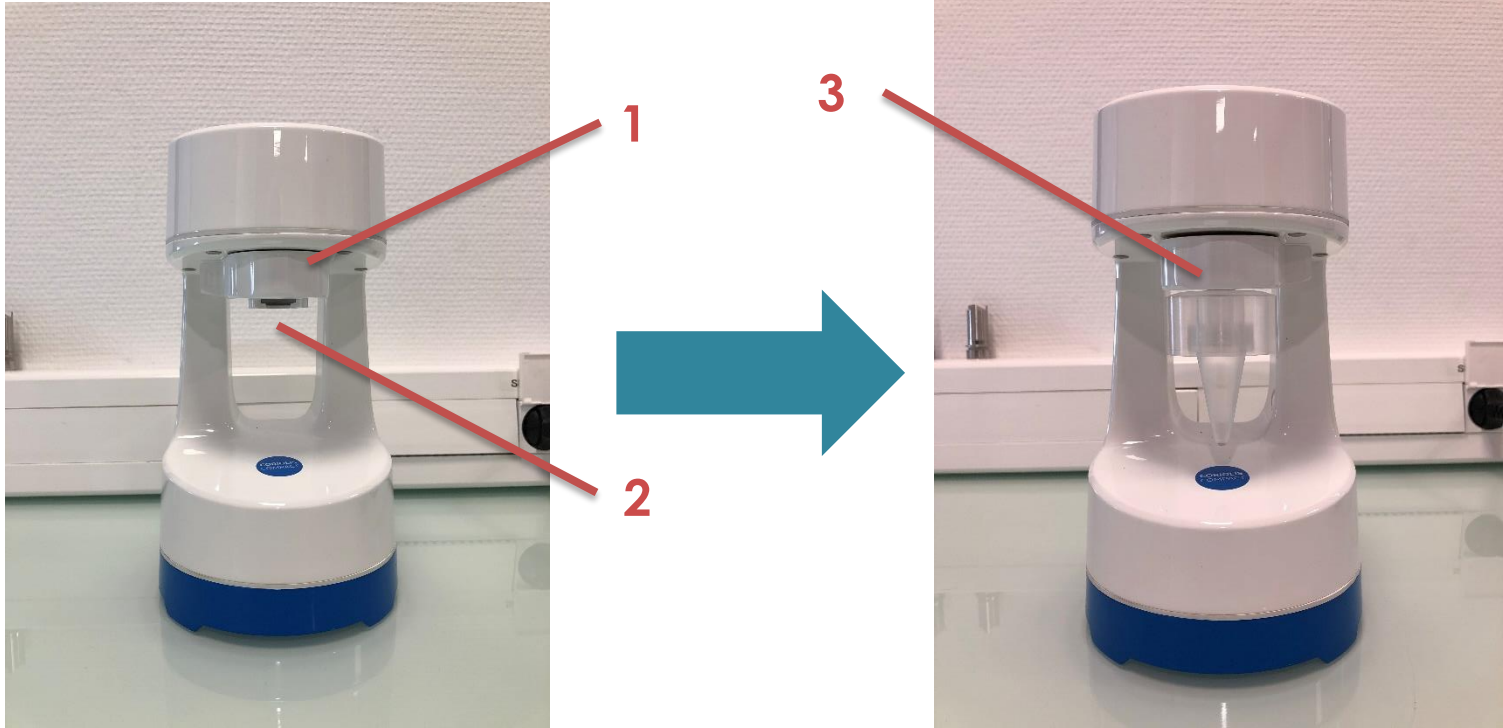

- 1** – Open the Quick Connect Collar by turning it on the left in open position
- 2** – Insert the cone with the air intake into the intended location
- 3** – Turn the Quick Connect Collar to the right to block the cone with the air intake in closed position



COROLIS COMPACT QUICK USER'S GUIDE

/ Recovery and suspension of the sample

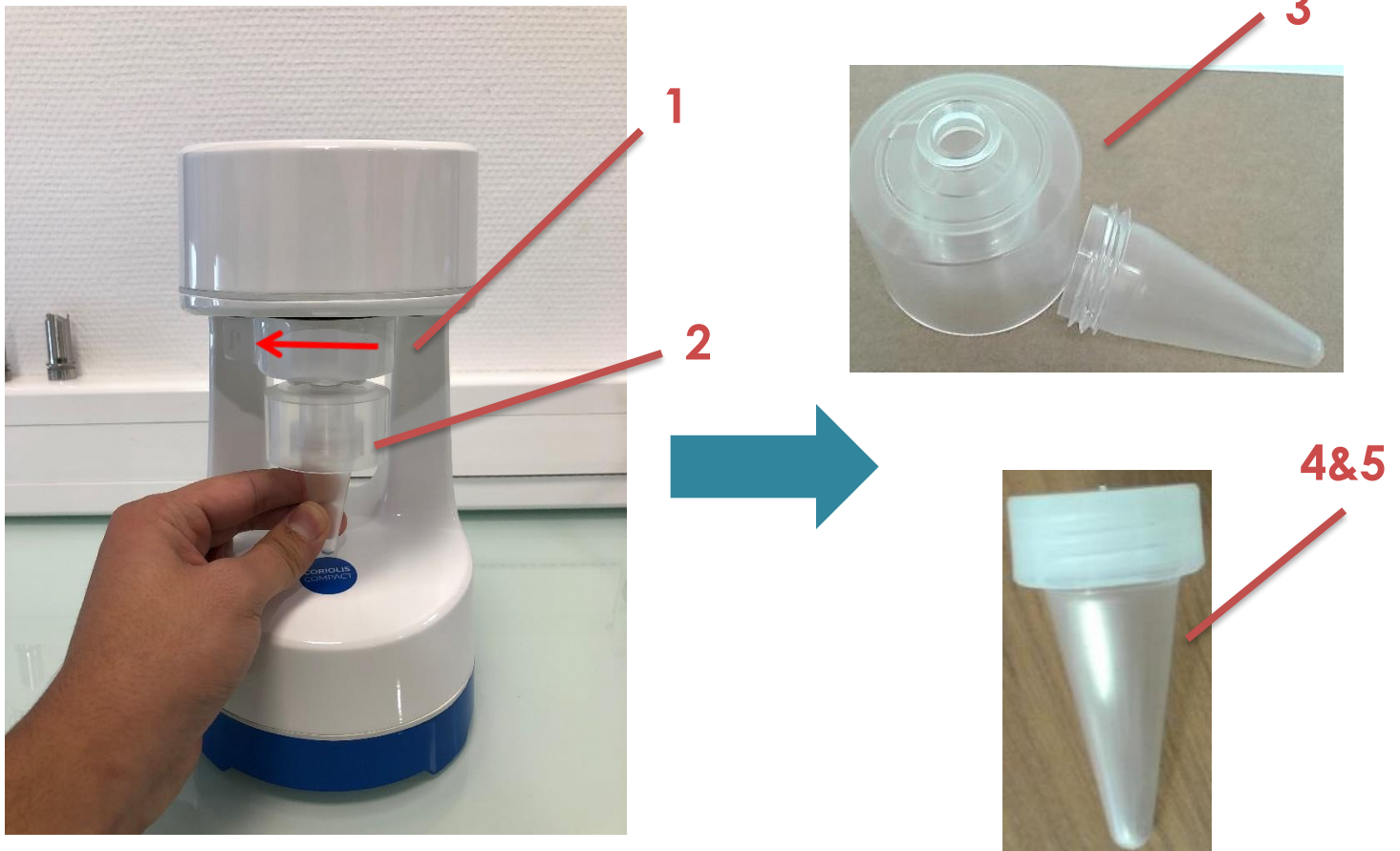

- 1** – Once sampling is finished, open the Quick Connect Collar on the left in order to release the cone with the air intake
- 2** – Remove the cone with the air intake
- 3** – Unscrew the air intake of the cone and screw the cap on it
- 4** – Store your sample or recover it with appropriate buffer
- 5** – Add your buffer by rinsing up and down cone walls. Scrap cone walls with a swab or the pipette tip



CORLIOLIS COMPACT QUICK USER'S GUIDE

/ Buttons and functions



1 – Screen: display the menu, collection protocols and device settings

2&2' – Play/Pause button: allow to turn on the device, start a collection cycle, pause a collection cycle and validate a choice when browsing the menu.

Start and stop the instrument by a long press on the play button

3 – Back button: allow to exit the menu, to stop a collection

4 – Up Arrow Button: Navigate inside the menu

5&5' – Down Arrow Button: Navigate inside the menu

Padlock: A long press of the button blocks the keyboard and avoids inadvertently stopping a collection once launched.



COROLIS COMPACT QUICK USER'S GUIDE

/ Turning the device on/off



- 1** – Switch on the device by a 3 sec long press on the "PLAY" button
- 2** – A self-test is run and then the main menu is display
- 3** – To turn off the unit, press the "PLAY" button 3 sec long
- 4** – An "Extinction" message will appear



CORIOLIS COMPACT QUICK USER'S GUIDE

/ Navigation in the menu



1 – Use the navigation buttons (up/down arrows) to navigate inside the menu

2 – The “PLAY” button will give access to the selected menus, validate a change or initiate an action

3 – The “BACK” button will bring you to the previous menu



CORIORIS COMPACT QUICK USER'S GUIDE

/ Immediate collection mode



1 – This mode allows you to immediately activate a collection

2 – Select the menu and press the PLAY button. The device will start collection immediately. A pause can be performed by pressing the “PLAY” button again

3 – To cancel the collection after a break, click the “BACK” button.

4/5 – A message “Exit current collection” will appear. Confirm with the “PLAY” button to finish collection and return to the main menu.



CORIORIS COMPACT QUICK USER'S GUIDE

/ Simple collection mode



1 – In this mode, you can create three different programs

2/3 – Select a program. Use the navigation buttons (up/down arrows) and the PLAY button to change the collection time or delay time to your liking.

4 – Once the program has been modified, select the “Start Collection” line and click the “PLAY” button to start collection.



CORIOLIS COMPACT QUICK USER'S GUIDE

/ Advanced collection mode



1/2 – In this mode, you can create three different programs. In addition to time and delay, it is possible to schedule cycles and set a pause time during collection between each cycle.

3 – Use the navigation buttons (up/down arrows) and the “PLAY” button to change the program parameters: collection time, delay, number of cycles and the pause between each cycle. Use the PLAY button to save your changes

4 – Once the program has been defined, select the “Start Collection” line and click the “PLAY” validation button to start collection.



CORIOLIS COMPACT QUICK USER'S GUIDE

/ Settings



In this menu, you will be able to modify parameters as:

- Date and hours
- Language (English/French)
- Screen saver (on/off mode)
- Contrast (blow/high)
- Bluetooth (on/off)

- Use the navigation buttons (up/down arrows) and the “PLAY” button to change the settings at your convenience.



CORIOLIS COMPACT QUICK USER'S GUIDE

/ Cleaning the Coriolis compact

- ▲ After each set of samples, the Coriolis Compact must be cleaned according to the following procedure:
 - ▲ Disconnect the charger
 - ▲ Position the plug on the jack power outlet
 - ▲ Clean the external parts of the Coriolis Compact with a wipe slightly soaked in water with a surfactant
 - ▲ If the power cable has been in contact with the contaminated environment, clean it in the same way
 - ▲ Wipe the assembly with a soft cloth



CORLIOLIS COMPACT QUICK USER'S GUIDE

/ Decontamination mode

- ▲ In case of collection in an area contaminated by biological agents, a decontamination step is required following the cleaning.
- ▲ The decontamination procedure detailed below is the procedure implemented by Bertin when performing the tests. The decontamination procedure should be adapted to the infectious risk.
 - ▲ Spray the external parts of Coriolis Compact with 12° chlorometric bleach
 - ▲ Incubate for 30 minutes
 - ▲ Rinse thoroughly with clean water
 - ▲ Dry with a soft cloth
- ▲ Note 1: Decontamination must always be carried out on equipment that has previously undergone a cleaning step.